

### Meets or exceeds the criteria for ASTM D 6298

#### Features and Components

DynaClad is used as a fiber glass-reinforced cap or flashing sheet in a variety of multi-ply roofing systems.

**Aluminum Foil Surface:** Provides high reflectivity, reducing heat load on the roof membrane and potentially lowering air conditioning energy costs.

**High-Quality SBS Rubber and Asphalt Blend:** Lends elasticity and flexibility to the sheet. The elongation and recovery properties allow the product to easily accommodate the continual expansion and contraction experienced on all roofs.

**Fiber Glass Reinforcement Mat:** Offers excellent dimensional stability and tensile strength and withstands differential movement. Because it has no thermal memory less time is needed to relax the sheet, allowing for ease of installation. The fiber glass mat also has good lay-flat characteristics.

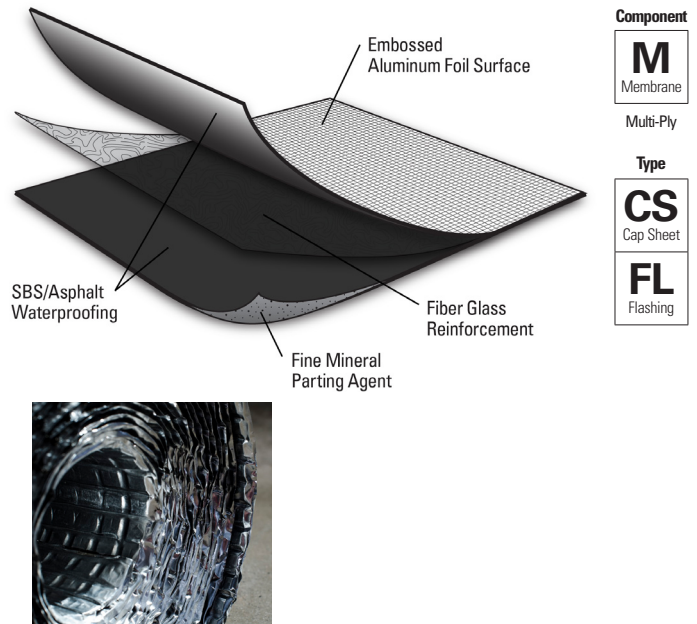

**System Compatibility** This product may be used as a component in the following systems. Please reference product application for specific installation methods and information.

Multi-Ply	BUR		APP		SBS				
	HA	CA	HW	HA	CA	HW	SA	MF	
Compatible with the selected multi-ply systems above									

Single Ply	TPO				PVC			EPDM		
	MF	AD	SA	IW	MF	AD	IW	MF	AD	BA
Do not use with single ply systems										

**Key:** HA = Hot Applied CA = Cold Applied HW = Heat Weldable SA = Self Adhered MF = Mechanically Fastened IW = Induction Weld BA = Ballasted AD = Adhered

#### Energy and the Environment

Test	Initial	3-Year Aged
Reflectivity (ASTM C 1549)	0.86	—
Emissivity (ASTM C 1371)	0.06	—
Solar Reflectance Index (SRI) - E 1980	91	—
Pre-Consumer Recycled Content	0%	
Post-Consumer Recycled Content	0%	

#### Peak Advantage® Guarantee Information

Systems	Guarantee Term
When used in most 2-5 ply JM SBS systems.*	Up to 30 years

\*Contact JM Technical Services for specific system requirements or guarantee terms.

#### Codes and Approvals



#### Product Application



- May be installed in Type IV asphalt, in an approved JM adhesive or using heat welding techniques
- Laps may be installed using heat-welding techniques
- If installed as a cap sheet, membrane must be cut into 11 foot sheets prior to application
- Refer to JM SBS modified bitumen specifications and detail drawings for application and slope information

#### Packaging and Dimensions

Roll Coverage*	95.8 ft <sup>2</sup> (8.9 m <sup>2</sup> )
Roll Length	32' 10" (10.01 m)
Roll Width	39 3/8" (1 m)
Roll Weight	100 lb (45.4 kg)
Rolls per Pallet	20
Pallet Weight	2,130 lb (966 kg)
Pallets per Truck*	22

\*Assumes a 4" side lap \*\*Assumes 48' flatbed truck.

Refer to the Safe Use Instructions and product label prior to using this product. The Safe Use Instructions are available by calling (800) 922-5922 or on the Web at [www.jm.com/roofing](http://www.jm.com/roofing).

**Meets or exceeds the criteria for ASTM D 6298**

**Tested Physical Properties**

Physical Properties		ASTM Test Method	Standard for ASTM D 6298 (Min.)	DynaClad	
				MD*	XMD**
Strength	Tensile Tear	D 5147	120 lbf (534 N)	185 lbf (823 N)	185 lbf (823 N)
	Peak Load at 0°F (-18°C)	D 5147	160 lbf/in (28 kN/m)	185 lbf/in (32.4 kN/m)	175 lbf/in (30.6 kN/m)
	Peak Load at 73.4°F (23°C)	D 5147	85 lbf/in (14.9 kN/m)	100 lbf/in (17.5 kN/m)	90 lbf/in (15.8 kN/m)
Longevity	Low Temp. Flexibility	D 5147	0°F (-18°C)	0°F (-18°C)	
	Thickness	D 5147	134 mil (3.4 mm)	145 mil (3.7 mm)	
	Elongation at Peak Load at 0°F (-18°C)	D 5147	3%	4%	4%
Installation	Dimensional Stability	D 5147	0.2%	0.2%	0.2%
	Net Mass per Unit Area	D 146	80 lb/100 ft <sup>2</sup> (36 kg/9.29 m <sup>2</sup> )	108 lb/100 ft <sup>2</sup> (49.0 kg/9.29 m <sup>2</sup> )	
	Roll Weight	D 146	N/A	100 lb (45.4 kg)	

\*MD = Machine Direction

\*\*XMD = Cross-Machine Direction

Note: All data represents tested values.